

**For Installation of Forrey Pendant No Lens Type.**

**Model.UFOR-95001,UFOR-95002,UFOR-95021,UFOR-95022,UFOR-95041,UFOR-95042  
UFOR-95061,UFOR-95062**

## Product drawing (dimensions)

**SUITABLE FOR WET LOCATIONS**

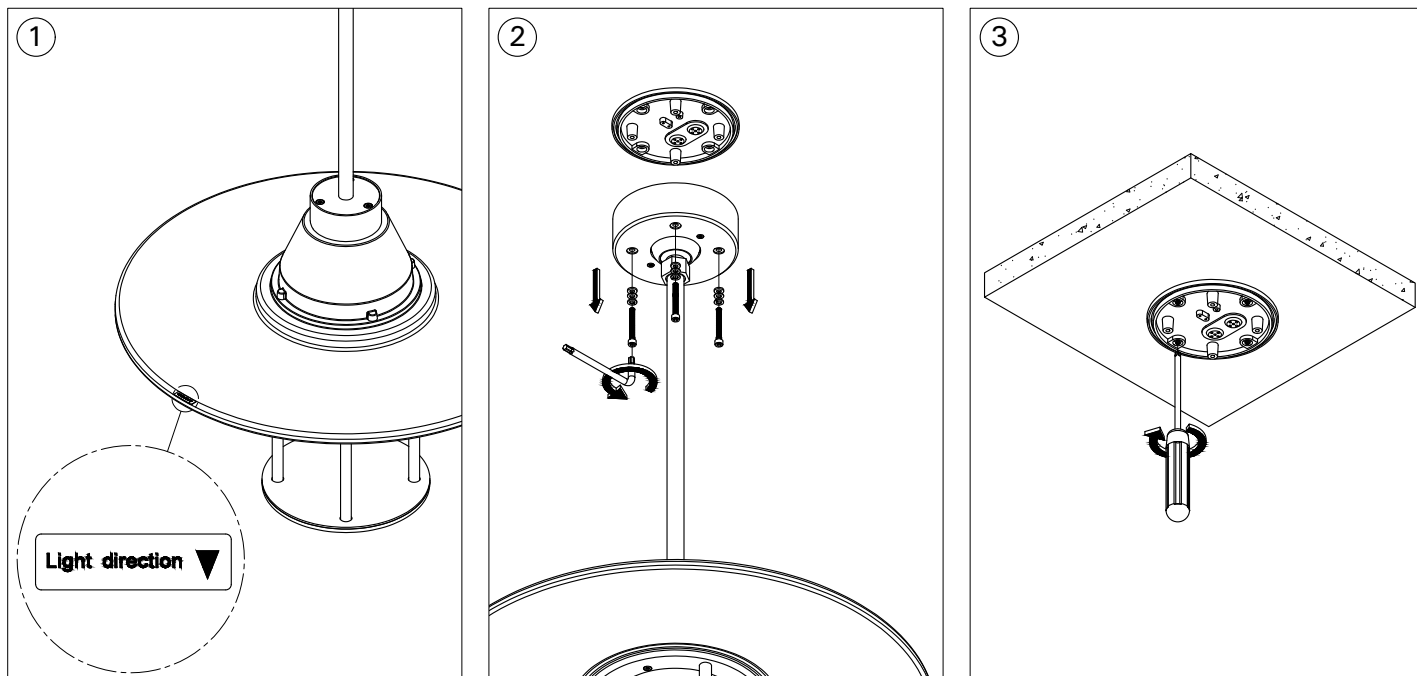
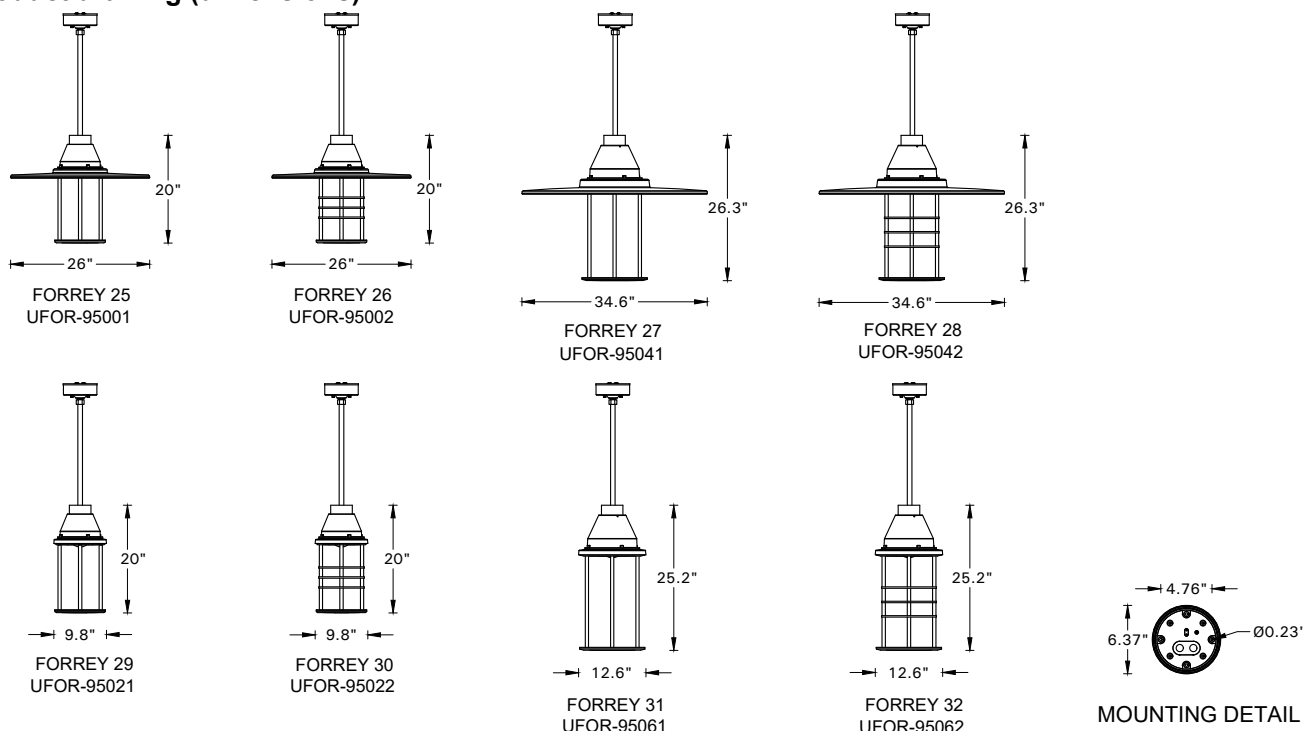

### Notice to installer :

- 1.WIRING INSTRUCTIONS** **Warning** : RISK OF FIRE AND ELECTRICAL SHOCK. : FIXTURE MUST BE INSTALLED BY A QUALIFIED ELECTRICIAN ONLY>FIXTURE IS INTENDED FOR INSTALLATION IN ACCORDANCE WITH THE NATIONAL ELECTRICAL CODE, LOCAL AND FEDERAL CODE SPECIFICATIONS. DISCONNECT POWER BEFORE SERVICING.
- 2.This fixture has a VOLTAGE SPECIFIC BALLAST**,Check that the supply voltage is the same as the installed ballast voltage.

**Ligman Lighting USA**

7144 NE Progress Court, Hillsboro  
Oregon, 97124, USA  
Tel : 503 645 0500 | Fax : 503 645 8100

